

TECHNICAL INFORMATION / INFORMACIÓN TÉCNICA INFORMATIONS TECHNIQUES / INFORMAÇÃO TÉCNICA

17-1137KIT

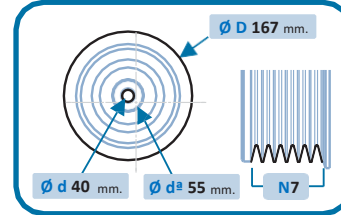

ANTI-VIBRATION KIT composed of crankshaft pulley
Ref. **17-1137** and alternator pulley Ref. **30-1299**
OEM → BMW: 11237800026

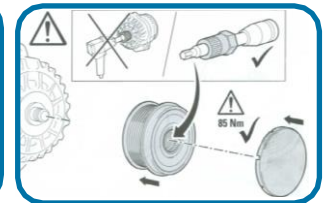
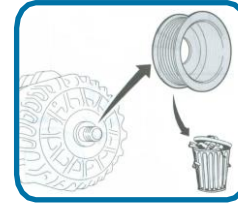

Assembly instruction:

This Crankshaft Pulley has been designed to work with the Overrunning Alternator Pulley Ref. 30-1299.
Failure to assemble the complete KIT will invalidate the warranty of your IJS GROUP product.
Tighten the torque to 130 NM and tighten the screw 180°.
When changing the pulley, respect the direction, change the belts and adjust them to the correct tension.

ES

Instrucciones de montaje:

Esta polea del cigüeñal ha sido diseñada para funcionar con la polea libre del alternador Ref. 30-1299.
No montar el KIT completo invalidará la garantía de su producto IJS GROUP.
Apriete el par a 130 NM y apriete el tornillo 180°.
Al cambiar la polea respetar la dirección, cambiar las correas y ajustarlas a la tensión correcta.

FR

Instructions de montage:

Cette poulie de vilebrequin a été conçue pour fonctionner avec la poulie d'alternateur à roue libre Réf. 30-1299.
Le fait de ne pas assembler le KIT complet annulera la garantie de votre produit IJS GROUP.
Serrez le couple à 130 NM et serrez la vis à 180°.
Lors du changement de poulie, respectez le sens, changez les courroies et réglez-les à la bonne tension.

PT

Instrução de montagem:

Esta polia do virabrequim foi projetada para funcionar com a polia do alternador de ultrapassagem ref. 30-1299.
A não montagem do KIT completo invalidará a garantia do seu produto do GRUPO IJS.
Aperte o torque a 130 NM e aperte o parafuso 180°.
Ao trocar a polia, respeite a direção, troque as correias e ajuste-as na tensão correta.







Vehicle linkage 17-1137KIT

Aplicación vehículo 17-1137KIT

Affectation véhicule 17-1137KIT

Vinculação do veículo 17-1137KIT

    				
BMW				
5 (F10)	525 d	204	N57 D30 A	03.2010 - 08.2011
5 (F10)	530 d	245	N57 D30 A	01.2010 - 08.2011
5 (F10)	535 d	299	N57 D30 B	09.2010 - 08.2011
5 Gran Turismo (F07)	530 d	245	N57 D30 A	08.2009 - 06.2012
5 Gran Turismo (F07)	530 d	211	N57 D30 A	09.2010 - 02.2017
5 Gran Turismo (F07)	530 d xDrive	245	N57 D30 A	06.2010 - 06.2012
5 Gran Turismo (F07)	535 d	299	N57 D30 B	03.2010 - 06.2012
5 Gran Turismo (F07)	535 d xDrive	299	N57 D30 B	03.2010 - 06.2012
5 Touring (F11)	525 d	204	N57 D30 A	09.2010 - 08.2011
5 Touring (F11)	530 d	245	N57 D30 A	06.2010 - 08.2011
5 Touring (F11)	535 d	299	N57 D30 B	09.2010 - 08.2011
7 (F01, F02, F03, F04)	730 d	245	N57 D30 A	09.2008 - 06.2012
7 (F01, F02, F03, F04)	740 d	306	N57 D30 B	09.2009 - 06.2012
7 (F01, F02, F03, F04)	740 d xDrive	306	N57 D30 B	09.2010 - 12.2012
X5 (E70)	xDrive 30 d	245	N57 D30 A	04.2010 - 07.2013
X5 (E70)	xDrive 40 d	306	N57 D30 B	09.2010 - 06.2013
X6 (E71, E72)	xDrive 30 d	211	N57 D30 A	04.2010 - 07.2014
X6 (E71, E72)	xDrive 40 d	306	N57 D30 B	07.2009 - 06.2014